

# ORLANDO, FL

## WATERFORD OAKS - RETAIL FOR LEASE

1440 N Alafaya Trl, Orlando, FL 32828

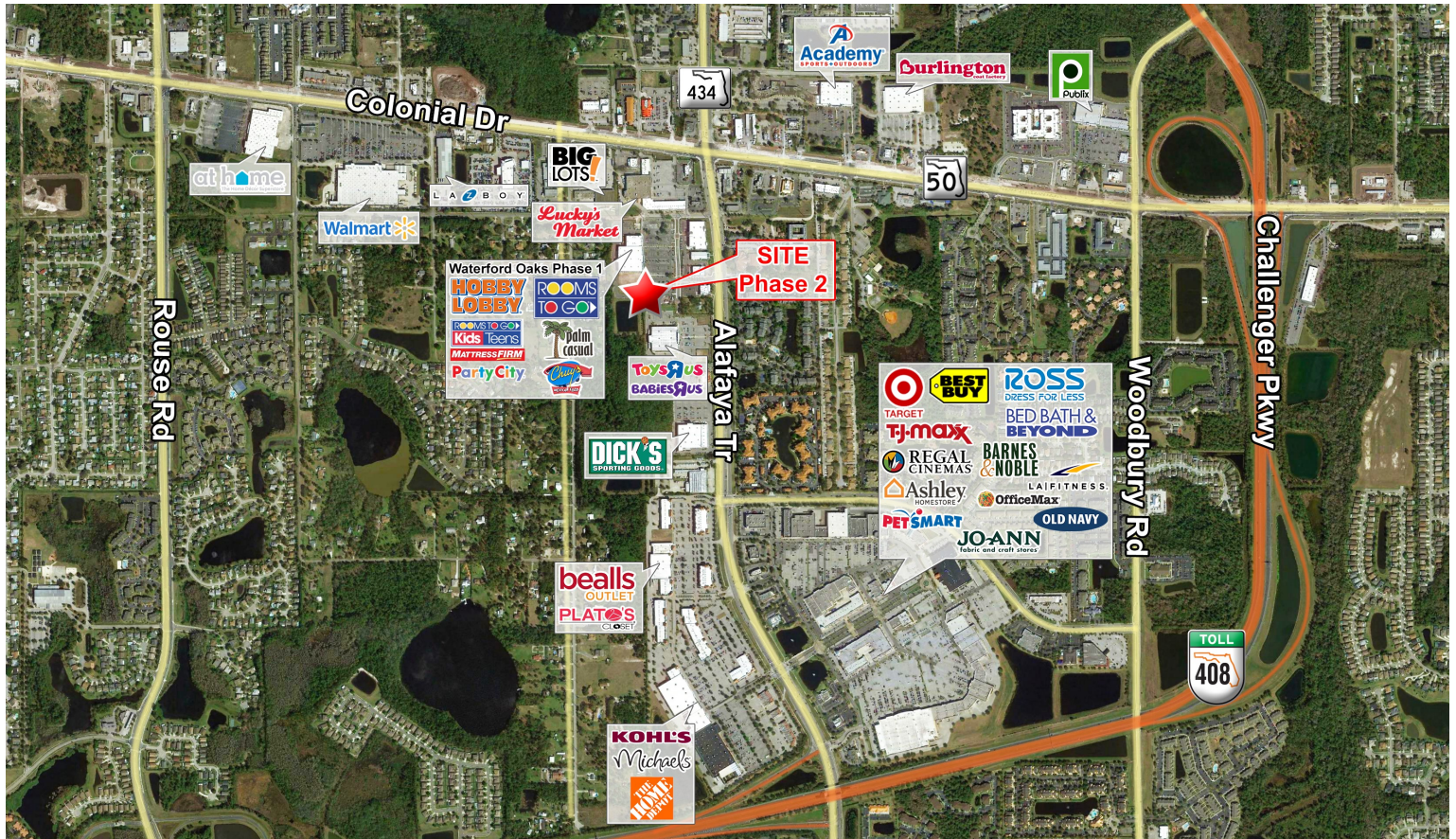

### FOR LEASE

**Now Leasing Phase 2  
Up to 55,000 sf available**

- Join Hobby Lobby, Party City, Rooms To Go, First Watch, Chuy's, and Mattress Firm
- Outparcel Available— 1,500 SF-55,000 SF Available
- Located near HWY 50 & Alafaya Trail intersection
- Pylon signage available
- Alafaya Trail Traffic Counts: 50,000 AADT

Demographics	1-Mile	3-Mile	5-Mile
Population	13,035	99,116	220,035
Avg. HH Income	\$49,847	\$59,727	\$67,567

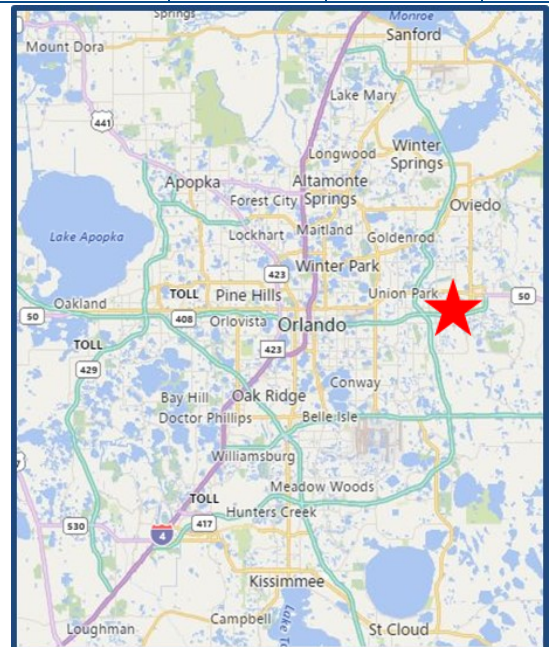

Heather Coons  
305-283-1521  
heather@blurockcommercial.com

3408 South Orange Ave.  
Suite B  
Orlando, FL 32806  
www.blurockcommercial.com

# ORLANDO, FL

## WATERFORD OAKS - RETAIL FOR LEASE

1440 N Alafaya Trl, Orlando, FL 32828



Heather Coons  
305-283-1521  
heather@blurockcommercial.com

3408 South Orange Ave.  
Suite B  
Orlando, FL 32806  
www.blurockcommercial.com



# ORLANDO, FL

## WATERFORD OAKS - RETAIL FOR LEASE

1440 N Alafaya Trl, Orlando, FL 32828

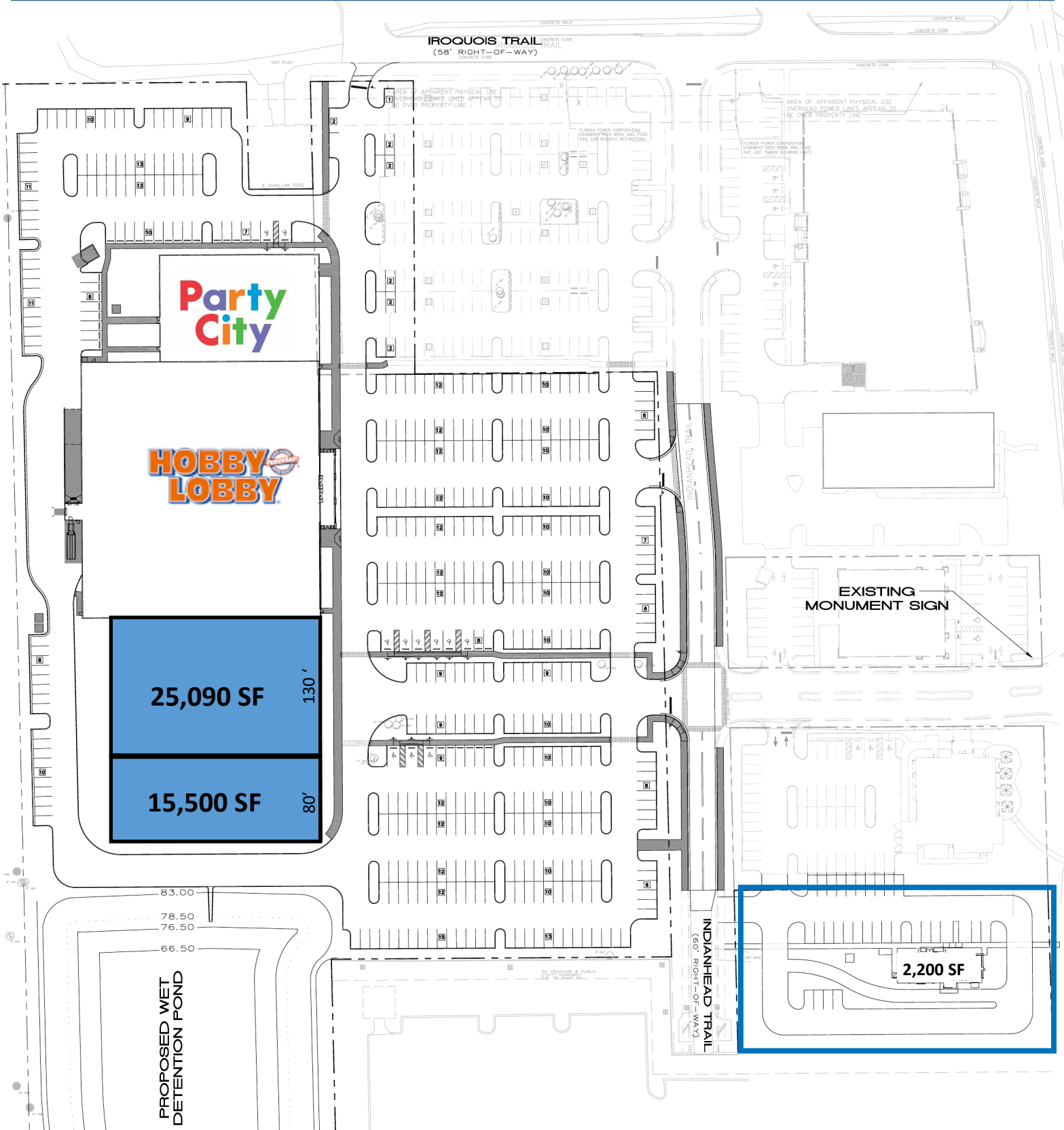

Heather Coons

305-283-1521

heather@blurockcommercial.com

3408 South Orange Ave.  
Suite B  
Orlando, FL 32806  
www.blurockcommercial.com