

WINTER PARK, FL

RETAIL FOR LEASE - 900sf



PROPERTY HIGHLIGHTS

909sf Prime Retail/Office Space

- Strip center with Jersey Mike's and uBreakiFix on US 17/92 in Winter Park
- Excellent visibility and easy access from 17/92
- 909sf built-out office
- At intersection of N. Orange Ave and 17/92
- AADT 33,000
- Across from brand new Orchard Supply

Demographics	1-Mile	3-Mile	5-Mile
Population	8,215	82,174	258,017
Avg. HH Income	\$75,682	\$83,406	\$67,461

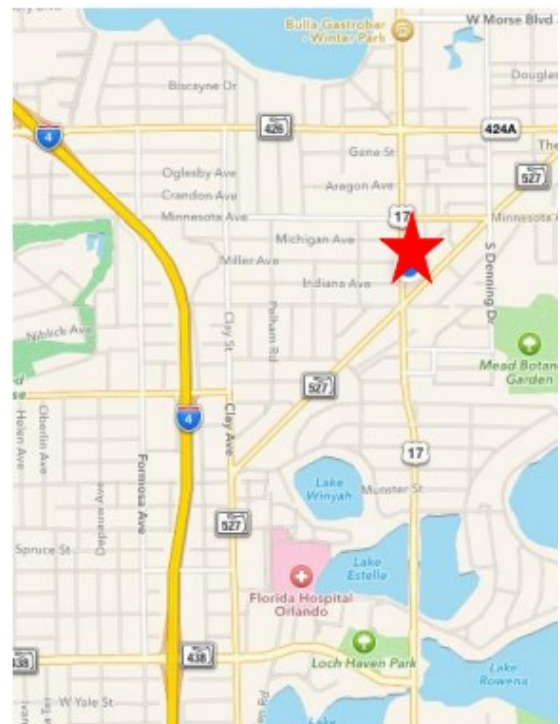

Cabot "CJ" Jaffee
407-493-6075
cj@blurockcommercial.com

Gradon Willard
321-287-1322
gradon@blurockcommercial.com

3408 South Orange Ave.
Suite B
Orlando, FL 32806
www.blurockcommercial.com

WINTER PARK, FL

RETAIL FOR LEASE - 900sf



FOR MORE INFORMATION CONTACT:

Gradon Willard
321.287.1322

Gradon@Blurockcommercial.com

Cabot "CJ" Jaffee
407.493.6075

CJ@Blurockcommercial.com

Blurock Commercial Real Estate
3408 S. Orange. Avenue, Suite B
Orlando, FL 32806
Fax: 407.583.4572
www.blurockcommercial.com

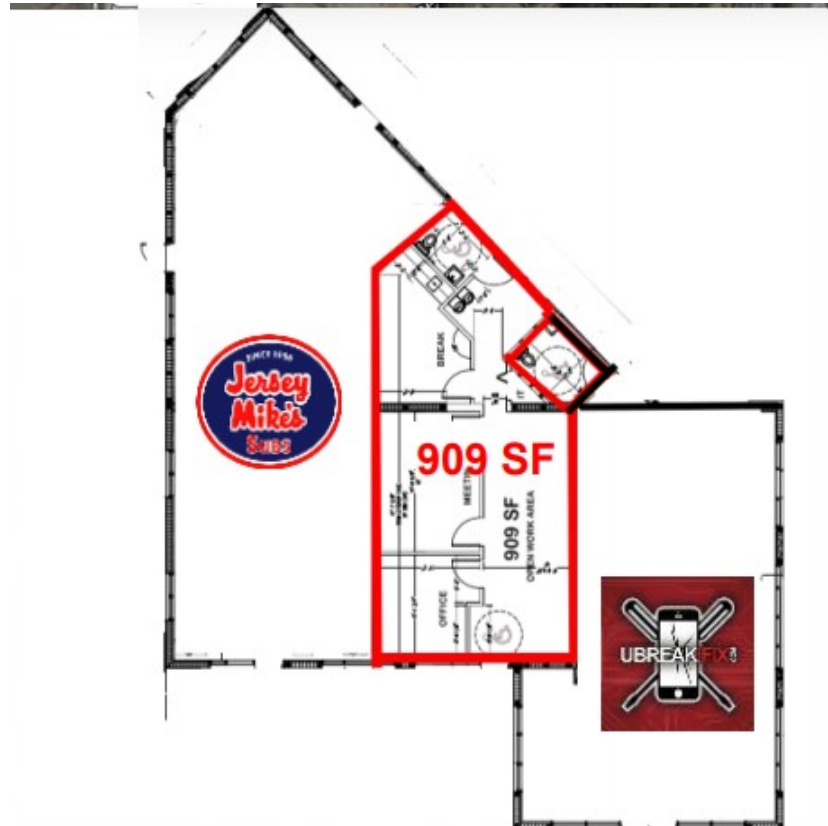

Cabot "CJ" Jaffee
407-493-6075
cj@blurockcommercial.com

Gradon Willard
321-287-1322
gradon@blurockcommercial.com

3408 South Orange Ave.
Suite B
Orlando, FL 32806
www.blurockcommercial.com